

atelier nomadic

# Building in dialogue with the natural environment

Olav Bruin

19.06.2024

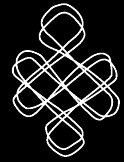

atelier nomadic



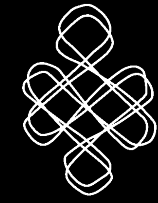

# Wild Coast Lodge, Sri Lanka

Built with Vinc Math & Chris Brown

Roof structure: *Dendrocalamus Asper bamboo* (Thailand)



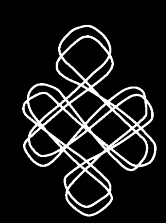

Radial knife

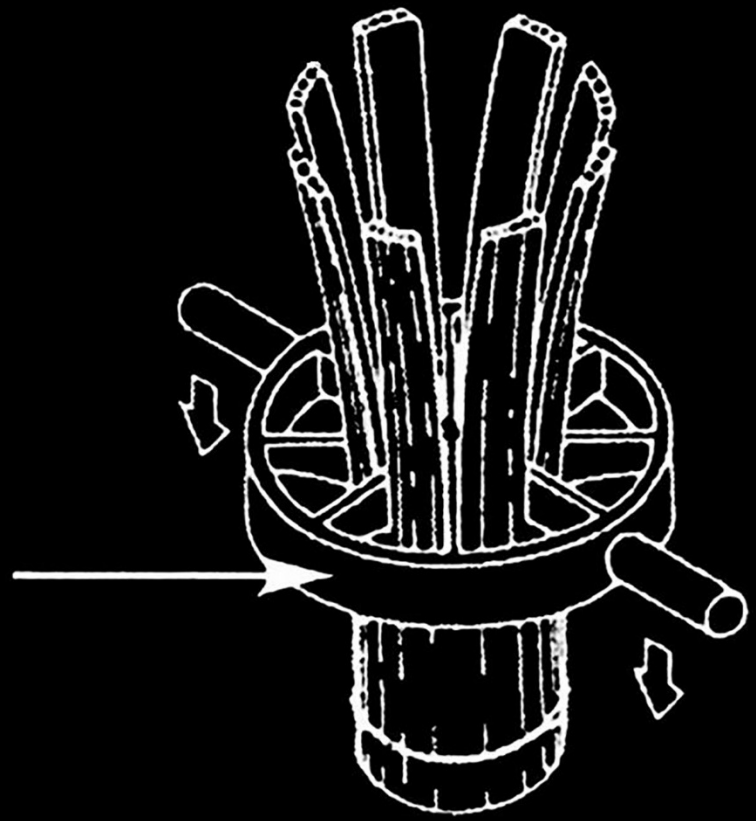



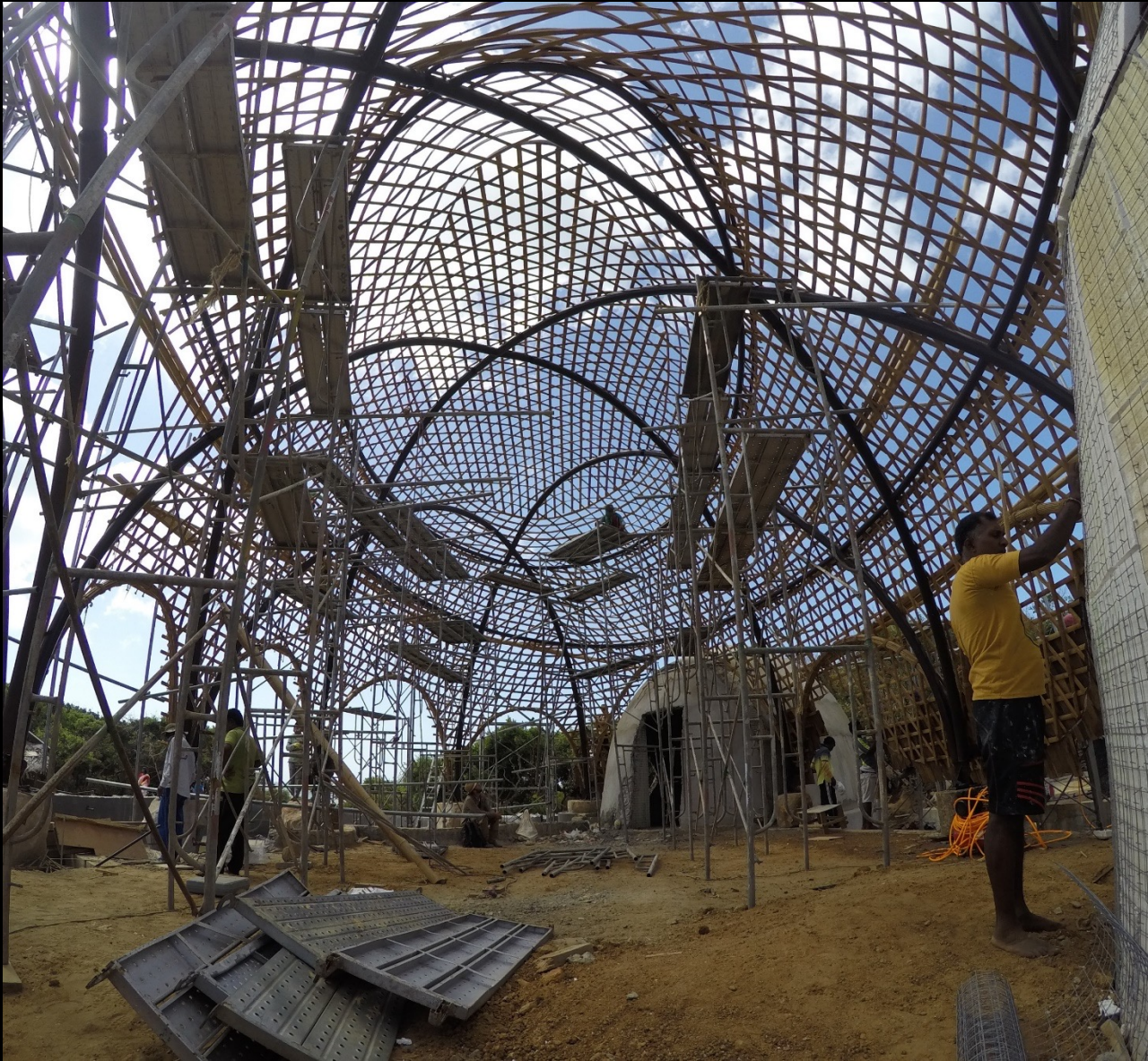
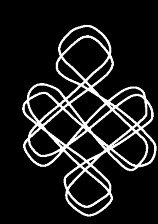

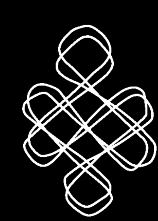

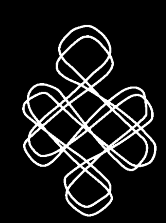



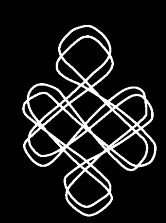

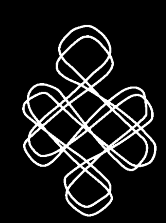

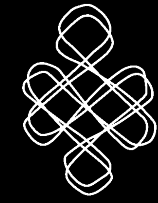

# Playa Viva, Mexico

Built with Jorg Stamm

Columns and roof structure:  
Walls:

*Guadua Angustifolia* bamboo (Colombia)  
*Phyllostachis Aurea* bamboo (Mexico)



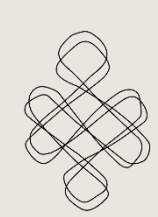

# Construction steps

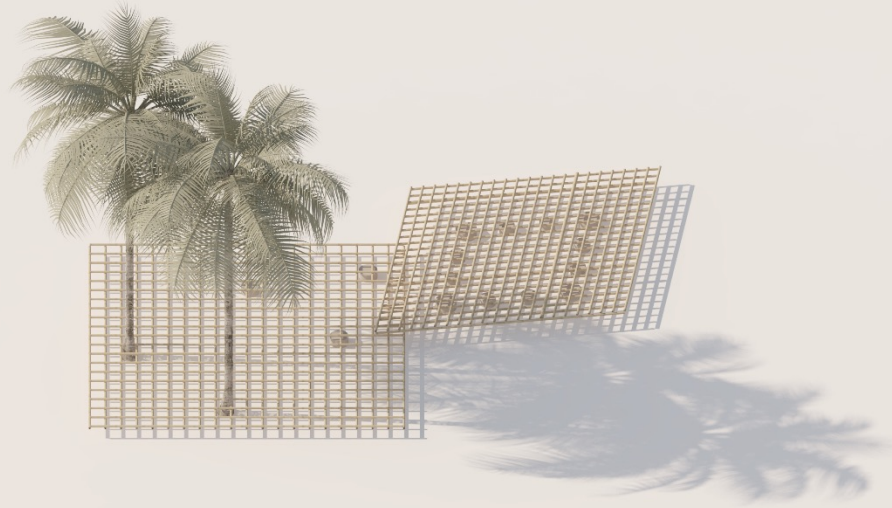

1

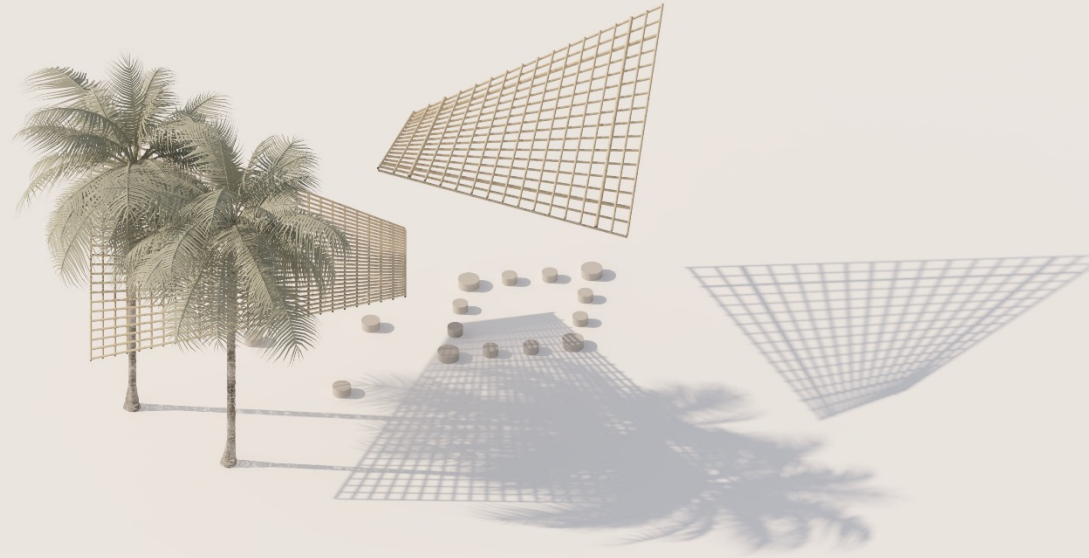

2

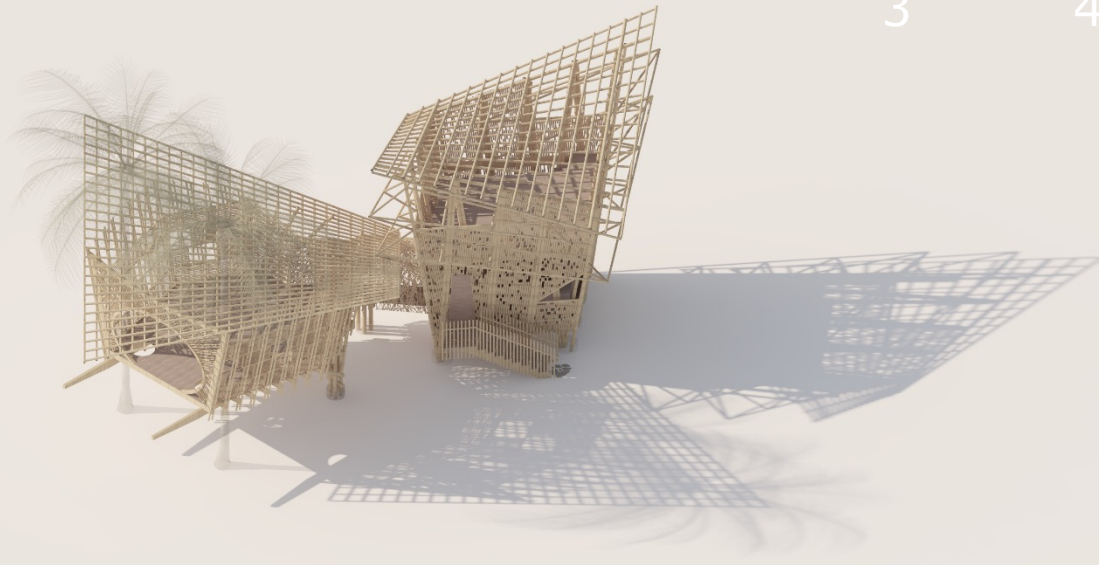

3

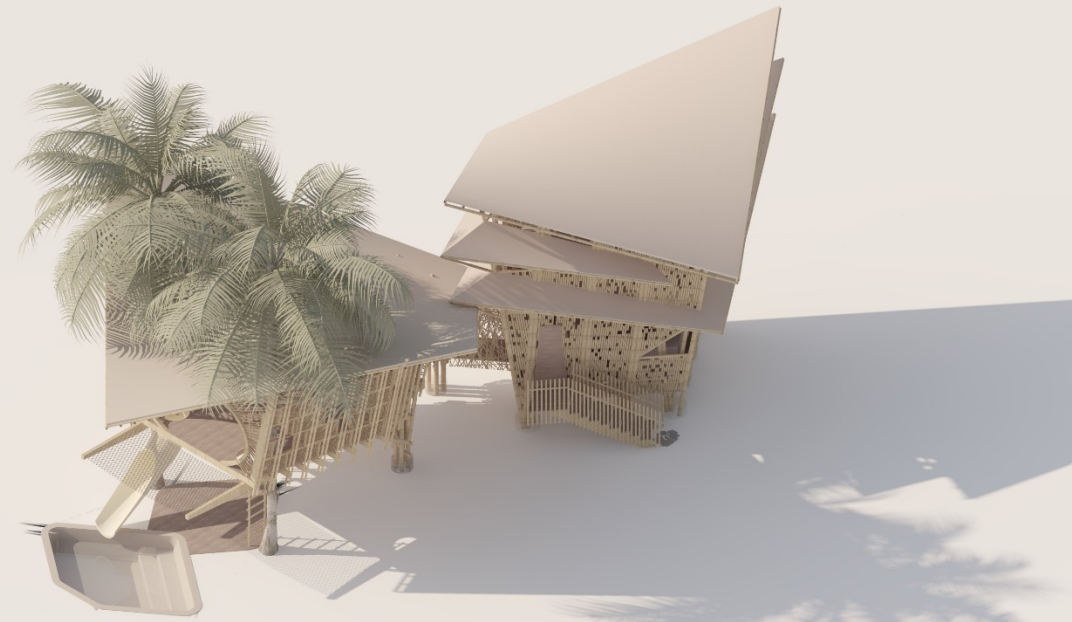

4

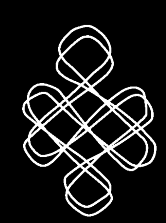

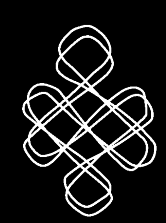

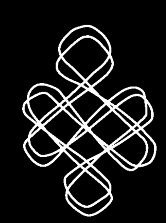

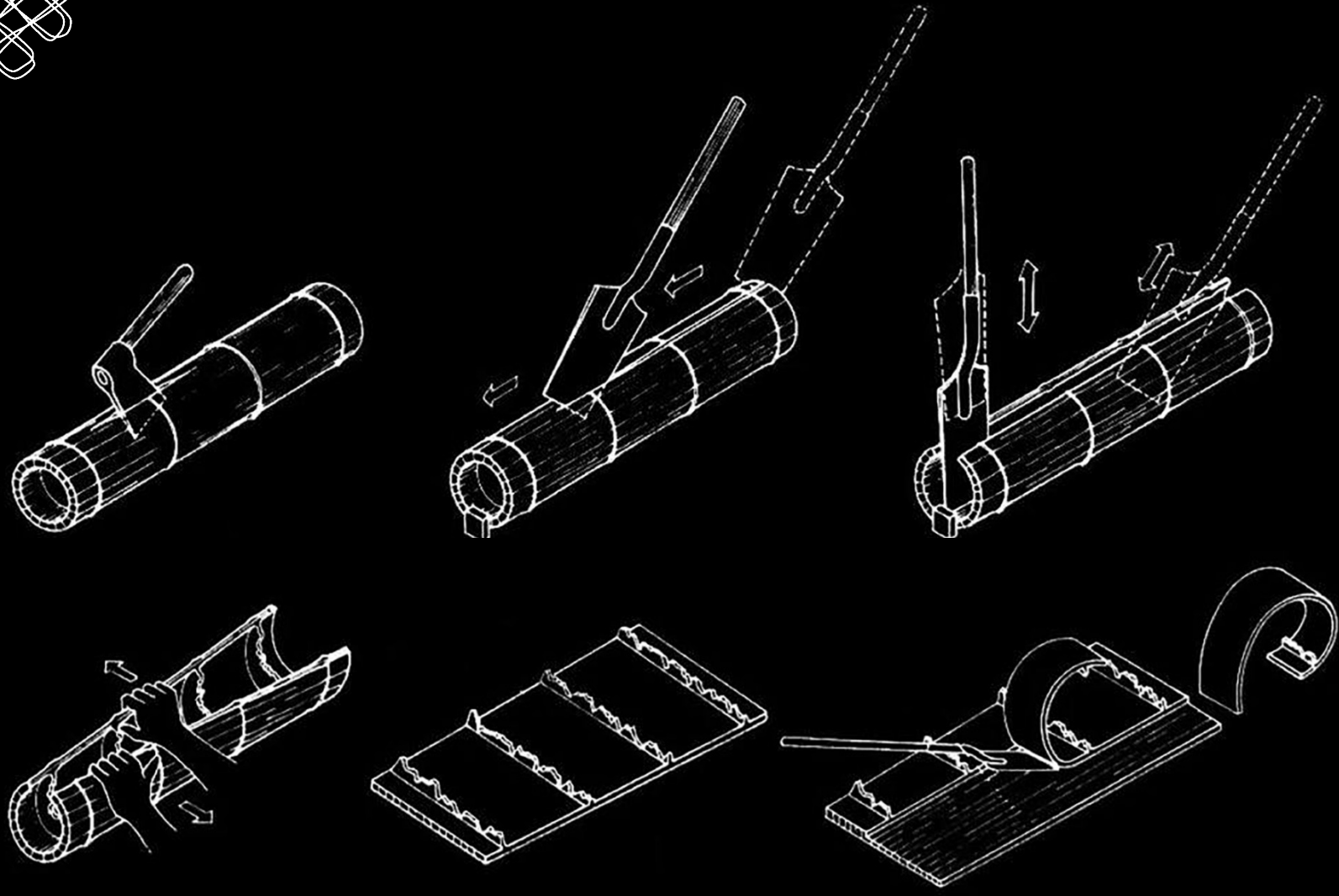
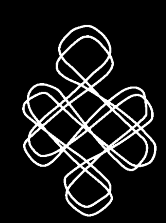



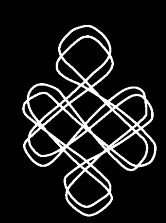

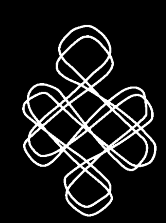

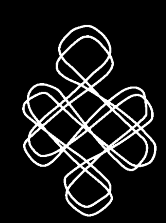

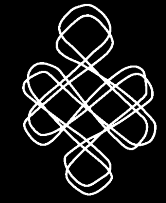

# Ting Irie restaurant, Abudhabi

Built with Vinc Math & Chris Brown

Structure: *Guadua Angustifolia bamboo* (Colombia)



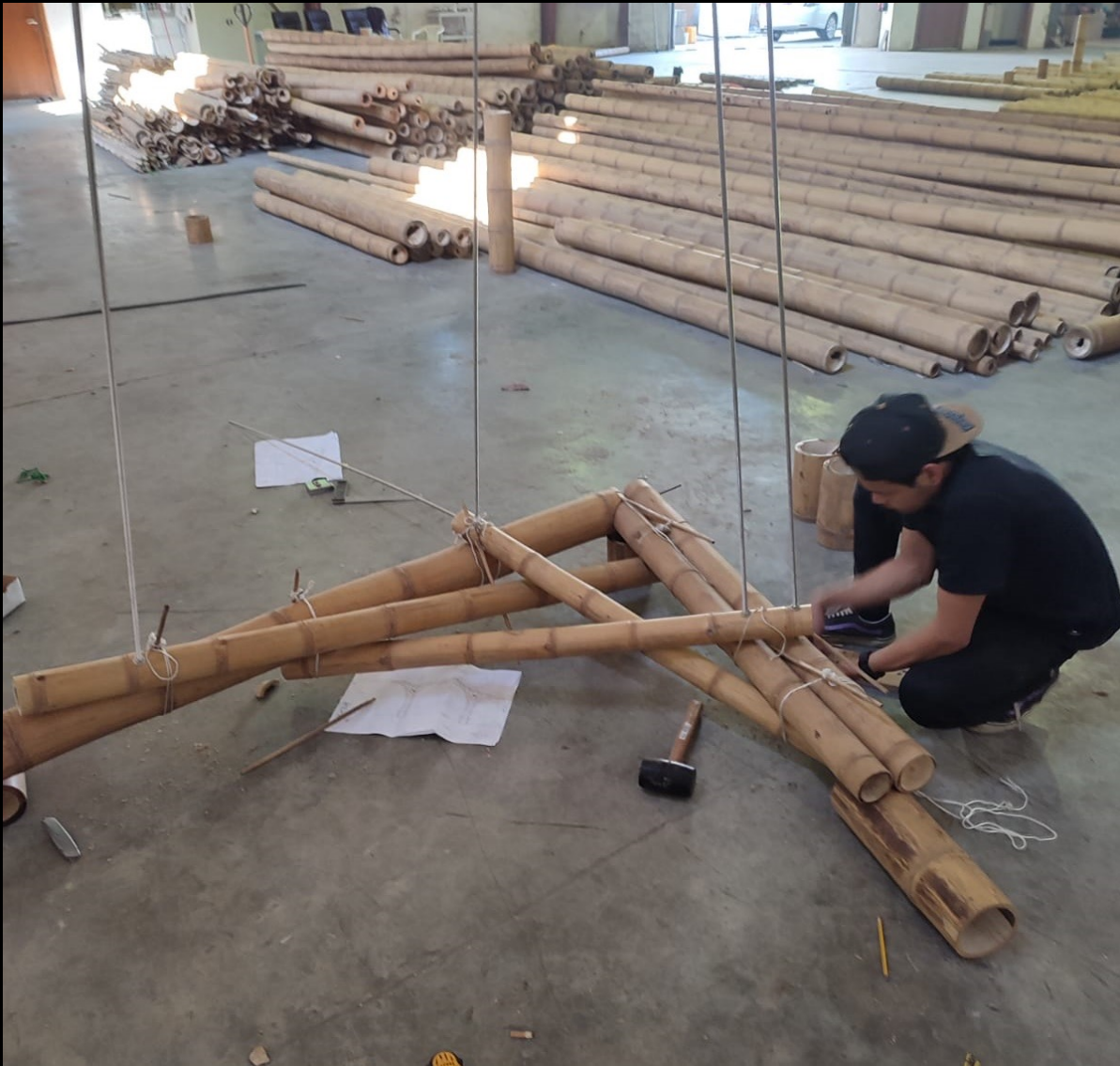
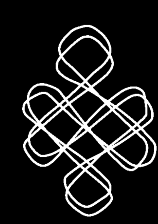

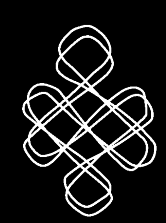

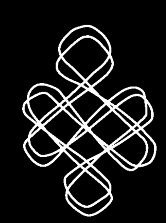

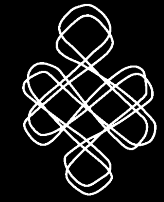

# Overwater Restaurant, Maldives

Built with Asali Bali

Main structure:  
Secondary structure:  
Interior finishes:

*Dendrocalamus Asper bamboo (Bali)*  
*Gigantochloa Apus bamboo (Bali)*  
*Gigantochloa Atroviolacea black bamboo (Bali)*





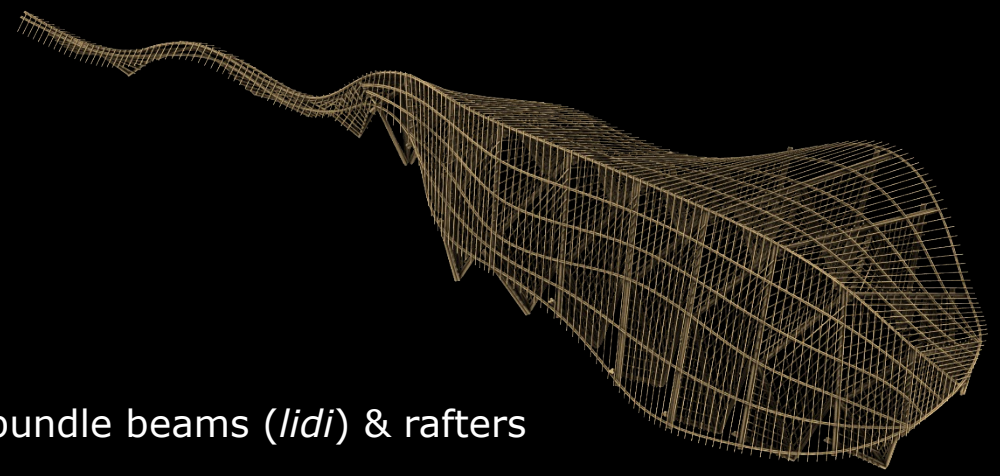
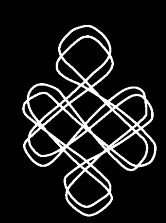

Bamboo splits bundle beams (*lidi*) & rafters

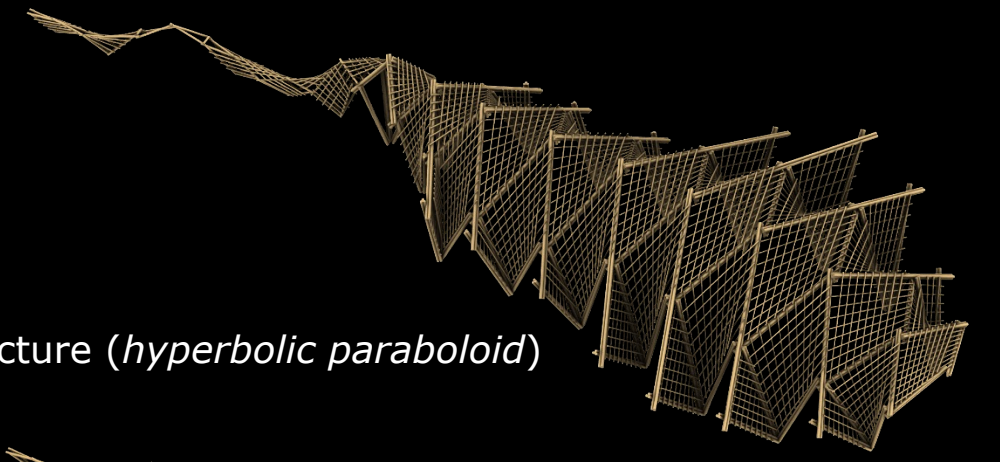

Secondary structure (*hyperbolic paraboloid*)

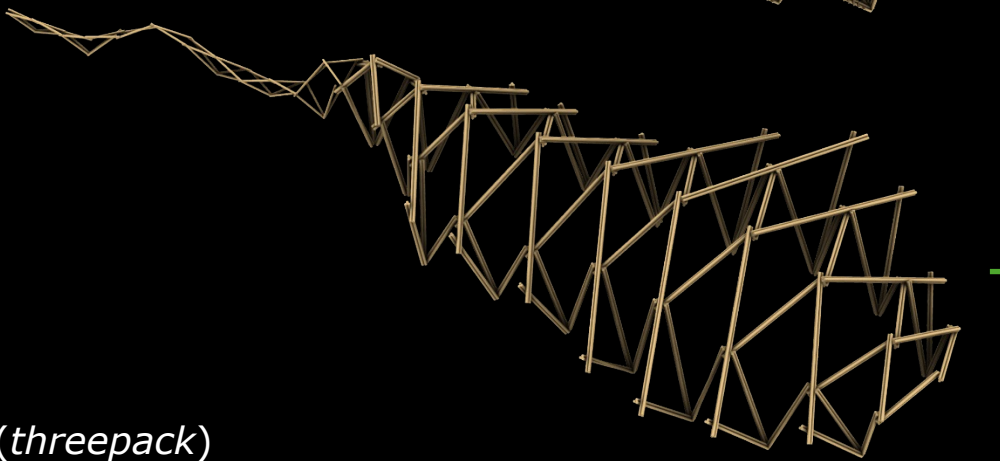

Main structure (*threepack*)



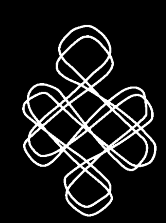

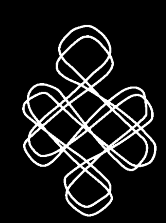

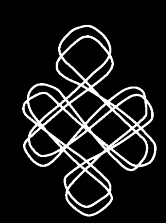

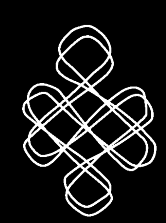



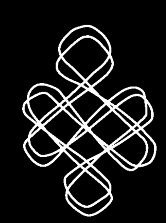

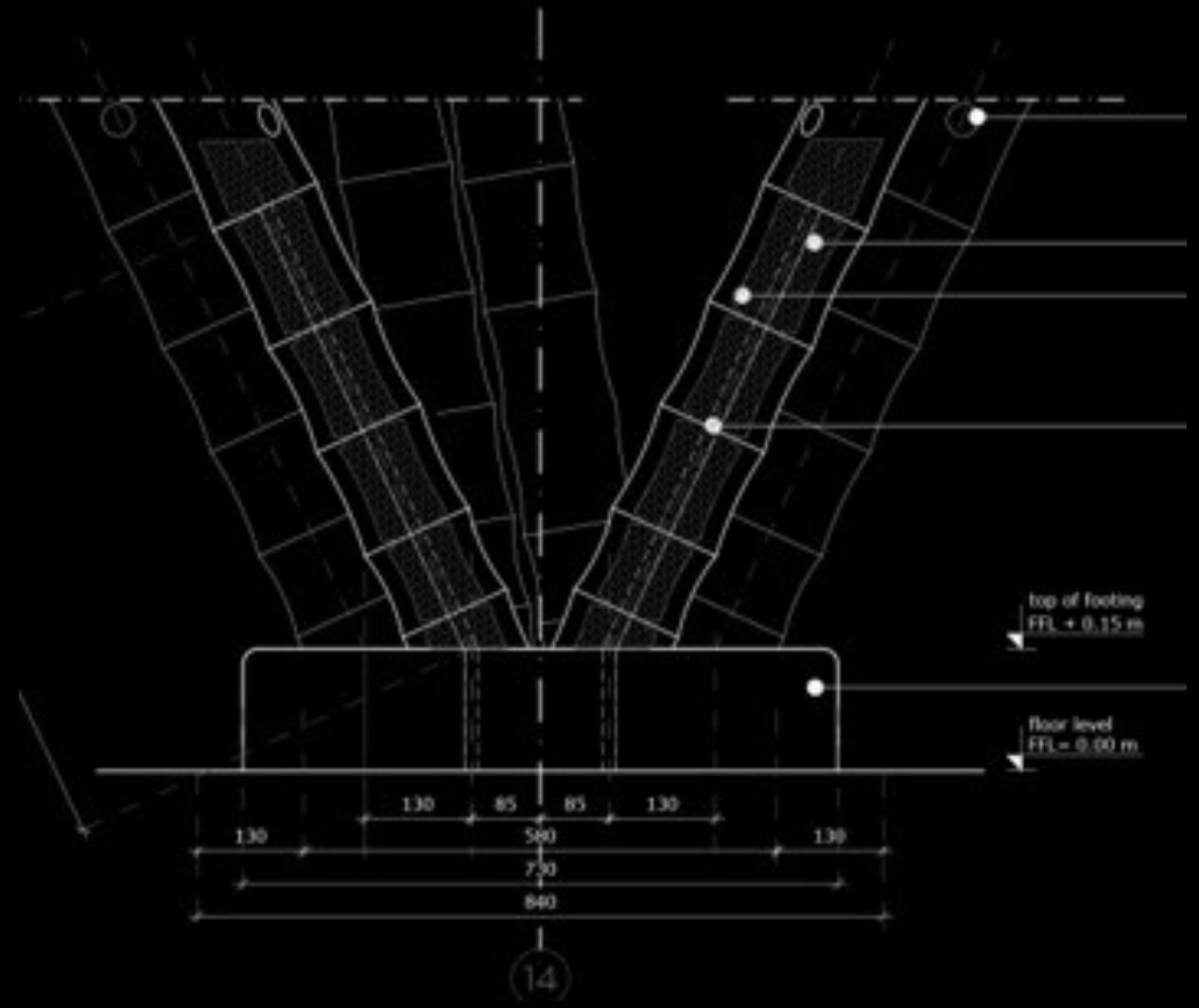
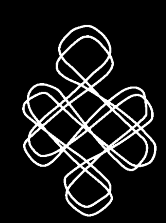



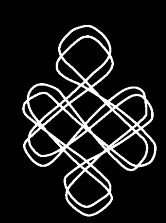

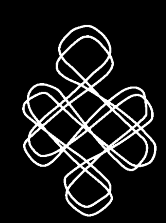

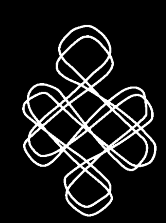





# Upcoming...



Fiji



India



Sri Lanka



Sri Lanka

Bangladesh



India



Dominican Republic



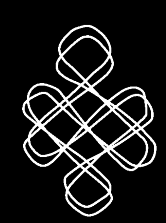

# Upcoming... Cooking School, Bangladesh

To be built with Jorg Stamm & Vinc Math  
Structural Engineer: Atelier One  
Local architect & engineer: Innstar



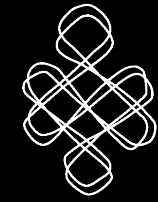

# Upcoming... Social Housing, Sri Lanka

Supported by SriLancare & the Hilti Foundation  
To be built by Una Bambu  
Structural Engineer: Base Bahay



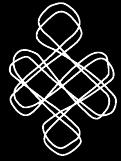

atelier nomadic

Thank you!